

AX-16-2022 | W. Pine Lake Circle

AERIAL VIEW

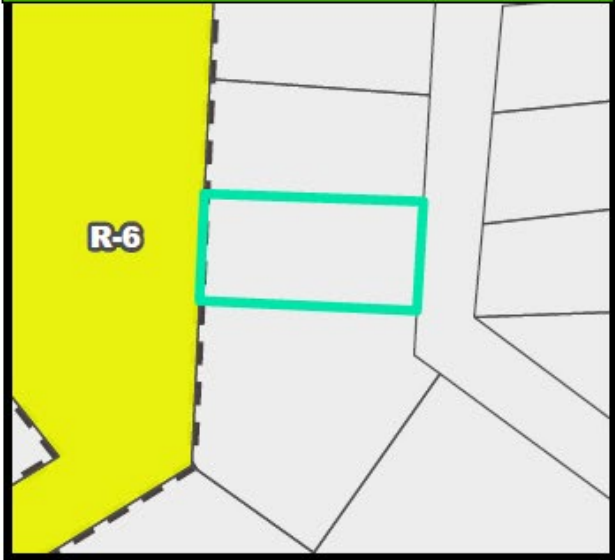

CURRENT ZONING



FUTURE LAND USE



AX-16-2022 | W. Pine Lake Circle

NATURAL / ENVIRONMENTAL FEATURES



SPECIAL EMPHASIS NEIGHBORHOODS

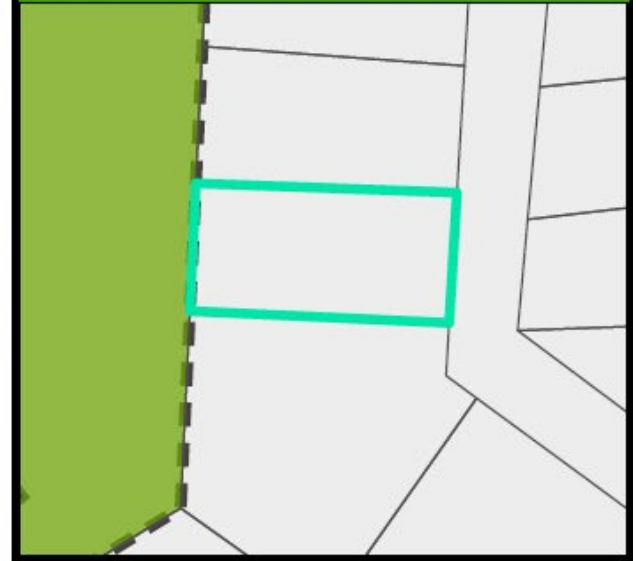

PRESERVATION OVERLAYS

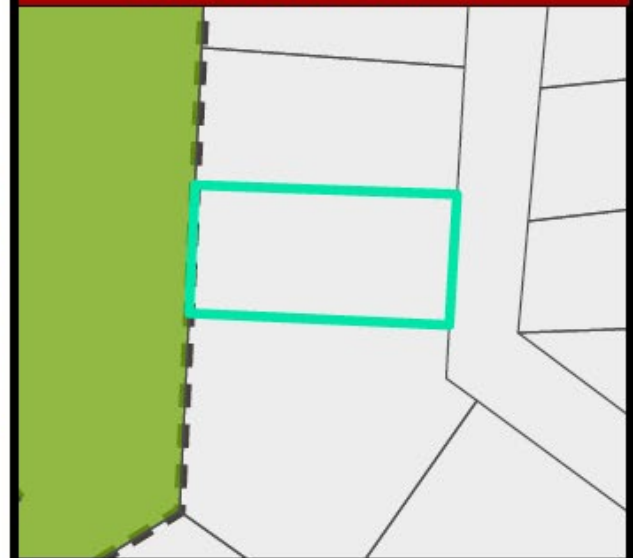

AX-16-2022 | W. Pine Lake Circle

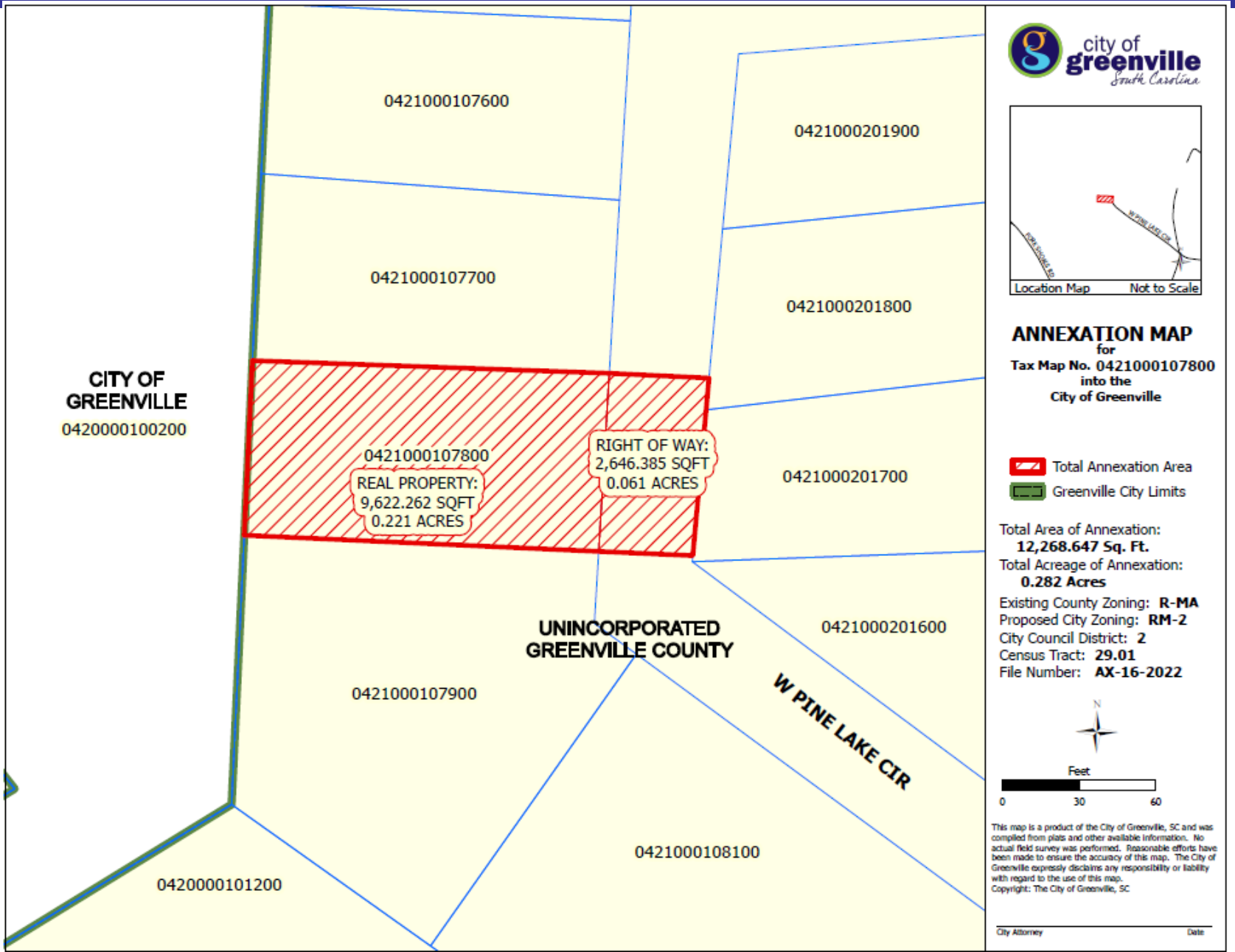

ANNEXATION MAP
for
Tax Map No. 0421000107800
into the
City of Greenville

- Total Annexation Area
- Greenville City Limits

Total Area of Annexation:
12,268.647 Sq. Ft.
Total Acreage of Annexation:
0.282 Acres
Existing County Zoning: **R-MA**
Proposed City Zoning: **RM-2**
City Council District: **2**
Census Tract: **29.01**
File Number: **AX-16-2022**

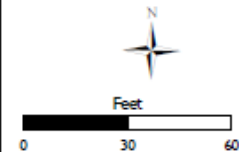

This map is a product of the City of Greenville, SC and was compiled from plats and other available information. No actual field survey was performed. Reasonable efforts have been made to ensure the accuracy of this map. The City of Greenville expressly disclaims any responsibility or liability with regard to the use of this map.
Copyright: The City of Greenville, SC



PLANNING AND ZONING

- Zoning – RM-2
- Overlay Zone – N/A
- Future Land Use – Parks/Open Space
- Special Emphasis – N/A

SERVICES

- Fire – City Fire Department
- Police – City of Greenville Zone 3
- Water – Greenville Water (6” on W. Pine Lake Circle)
- Sewer – Metro
- Sanitation – Greater Greenville
- City Council – District 2 (Flemming)
- Transportation – County

STAFF RECOMMENDATION

Recommend approval of annexation and rezone of the property.

EFFECT OF PLANNING COMMISSION DECISION

- Recommend approval of annexation and RM-2 rezoning request by a vote of 6-0.