

APPLICANT

City of Greenville

REQUEST

ANNEXATION of approximately 0.36 acre of **MARKET POINT DRIVE** Right-of-Way from Greenville County to the City of Greenville.

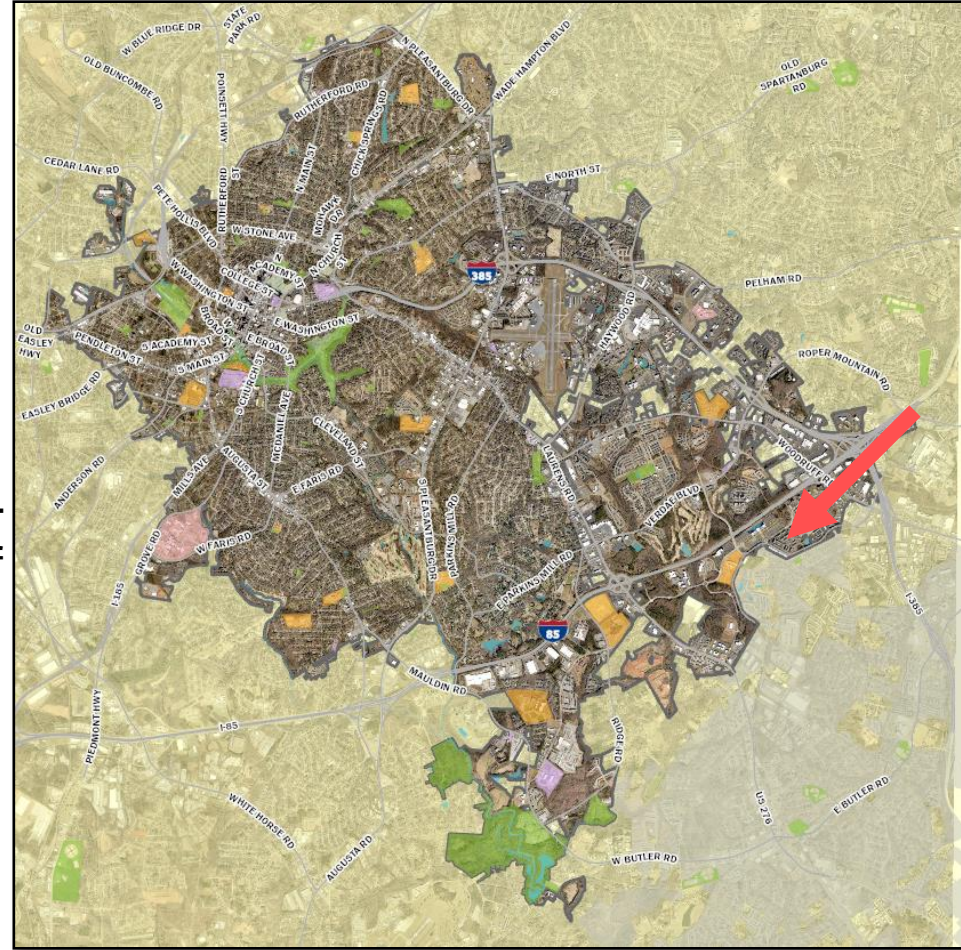

AX-22-2023 | Market Point Drive ROW



ANNEXATION REVIEW COMMITTEE

AX-22-2023 | Market Point Drive ROW

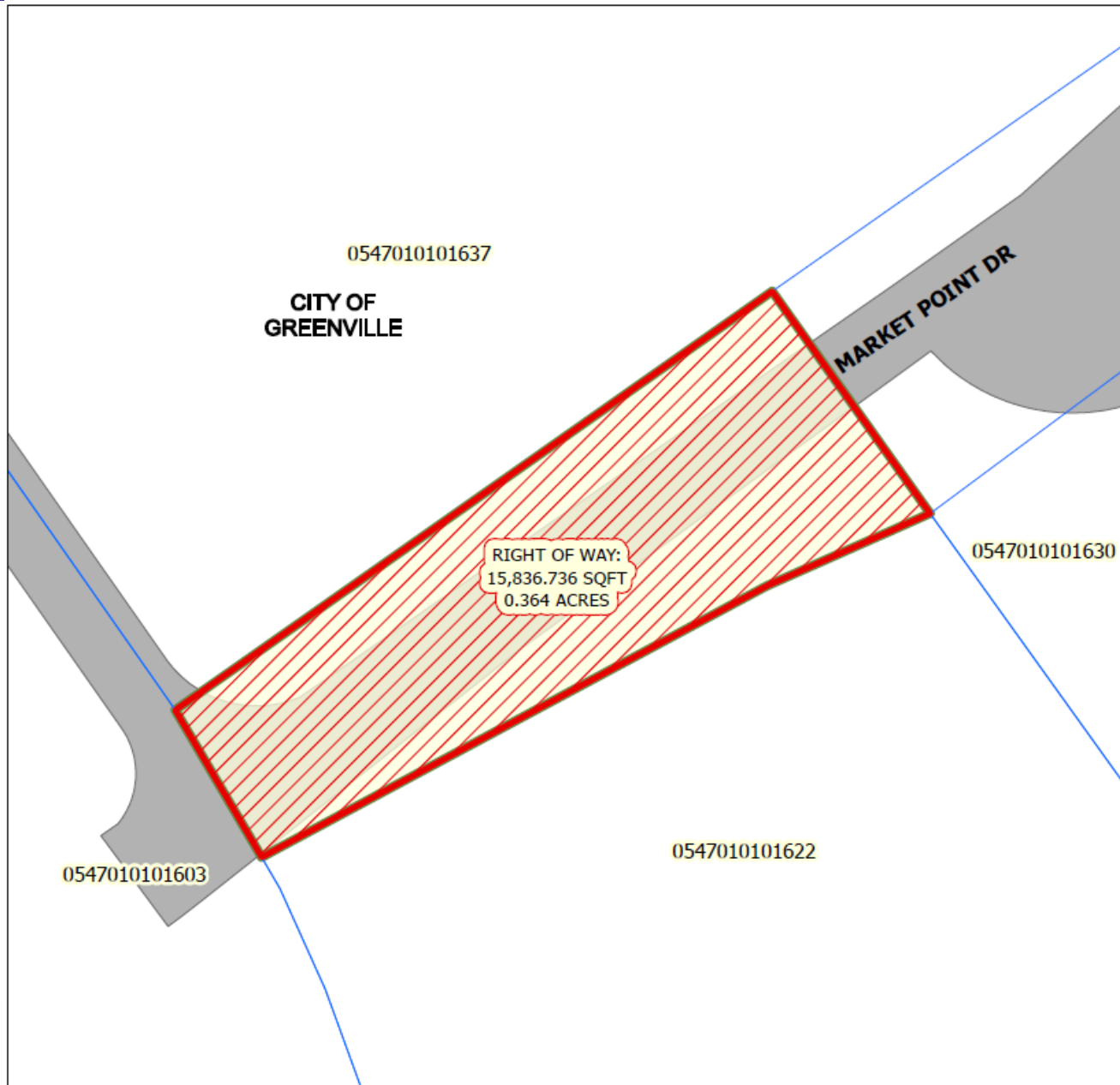

ANNEXATION MAP

No Real property. Annexation of Market Point Drive ROW.

- Total Annexation Area
- Greenville City Limits

Total Area of Annexation:
15,836.736 Sq.Ft.
Total Acreage of Annexation:
0.364 Acres

Existing County Zoning: **N/A**
Proposed City Zoning: **N/A**
City Council District: **4**
File Number: **AX-22-2023**

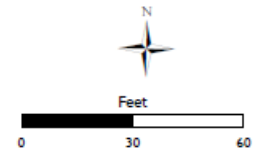

This map is a product of the City of Greenville, SC and was compiled from plats and other available information. No actual field survey was performed. Reasonable efforts have been made to ensure the accuracy of this map. The City of Greenville expressly disclaims any responsibility or liability with regard to the use of this map.
Copyright: The City of Greenville, SC

City Attorney _____ Date _____



PLANNING AND ZONING

- Zoning – N/A
- Overlay Zone – N/A
- Future Land Use – N/A
- Special Emphasis – N/A

SERVICES

- Fire – Greenville City Fire Department
- Police – City of Greenville Zone 3
- Water – N/A
- Sewer – N/A
- Sanitation – N/A
- City Council – District 4 (Brasington)
- Transportation – City

STAFF RECOMMENDATION

Recommended approval for annexation of right-of-way.

PLANNING COMMISSION DECISION

- No recommendation required as rights-of-way are not zoned